

REPAIR AND MAINTENANCE

Chain and Rear Tire Replacement

Tools required: Phillips screwdriver, 10mm wrench, two (2) 8mm wrenches, and two (2) 17mm wrenches.

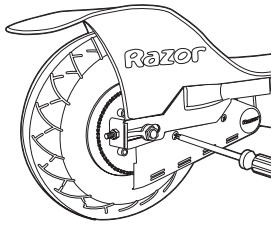

1 With a Phillips screwdriver, loosen the two screws and remove the chain guard.

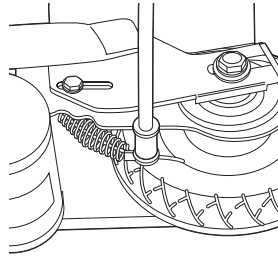

2 With a 10mm wrench, loosen the brake cable anchor and disconnect the cable.

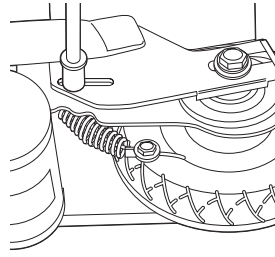

3 With two 8mm wrenches, loosen brake housing anchor and disconnect. Keep the spacer and bolts together.

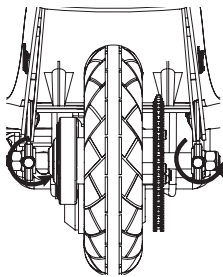

4 With a 10mm wrench, loosen both axle adjusters an equal amount, approximately five turns.

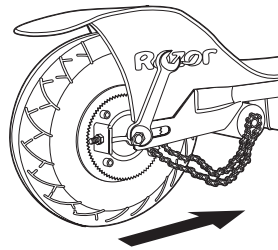

5 With two 17mm wrenches, loosen the axle. Slide the wheel forward to loosen the chain.

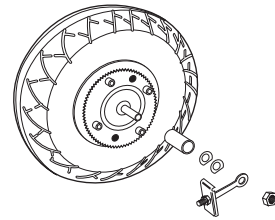

6 Remove wheel. Note the sequence of the hardware.

Right Side (Throttle)

Spacer
Washer (clipped)
Washer (plate cut)
Axle Adjusting Eye Assembly
Locknut

Left Side (Brake)

Spacer
Washer (flat)
Washer (flat)
Washer (clipped)
Brake Plate
Axle Adjusting Eye Assembly
Washer (plate cut)
Locknut

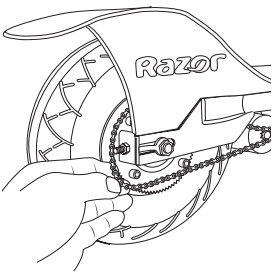

7 Install new chain or wheel by maneuvering the chain onto the sprocket and slipping the axle into the slots on the frame.

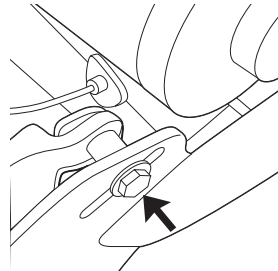

8 To hook up the brake housing anchor, align the cable guide adjuster and install the spacer and bolt. Do not tighten until final step.

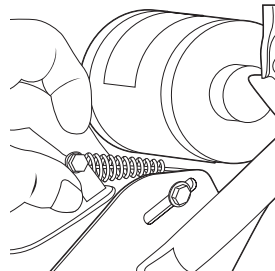

9 Install the brake spring and thread the cable wire into the cable anchor. Thread the cable to its original position and tighten securely.

Need Help? Visit our web site for replacement parts, product support and a list of authorized service centers at www.razor.com or call toll-free at 866-467-2967 Monday - Friday 8:00AM - 5:00PM Pacific Time.

REPAIR AND MAINTENANCE

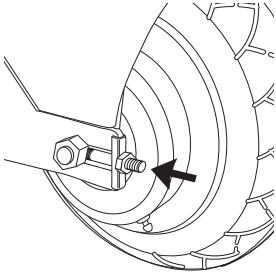

10 Install the axle adjusters and axle nuts. Tighten until they just barely hold the hardware in place.

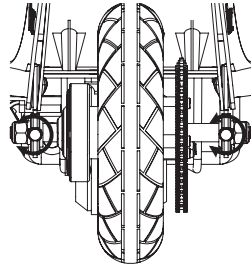

11 Tighten both axle adjusters the same number of turns to fine-tune the tension on the chain and center the wheel.

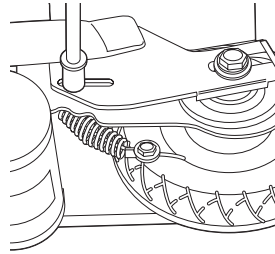

12 Tighten the brake housing anchor securely. Test ride and check. Readjust as needed.

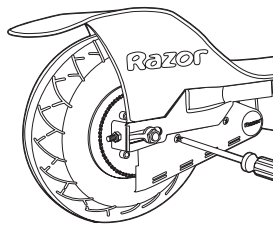

13 Replace the chain guard.

□ Front Tire Replacement

Tools required: two (2) 17mm wrenches and a flathead screwdriver.

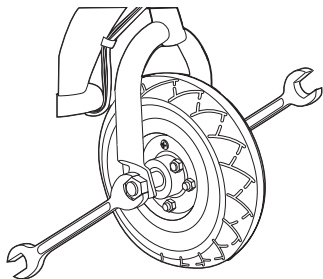

1 Using two 17mm wrenches, loosen the front axle bolts by turning the wrenches counter clockwise.

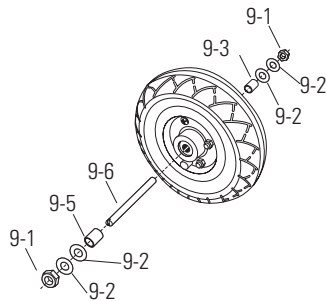

2 Remove wheel and install replacement wheel.

Right Side (Throttle)

- 9-3 - (Short) spacer
- 9-2 - Washer
- 9-2 - Washer
- 9-1 - 17mm locknut

Middle

- 9-6 - Front axle bolt

Left Side (Brake)

- 9-5 - (Long) spacer
- 9-2 - Washer
- 9-2 - Washer
- 9-1 - 17mm locknut