

REPAIR AND MAINTENANCE

Chain and Rear Tire Replacement

Tools required: Phillips screwdriver, 10mm wrench, two (2) 8mm wrenches, and two (2) 13mm wrenches.

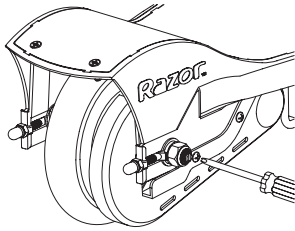

1 With a Phillips screwdriver, loosen the two screws and remove the chain guard.

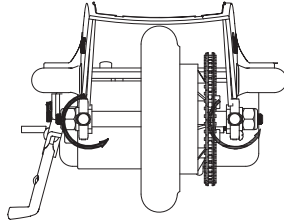

2 With a 10mm wrench, loosen both axle adjusters an equal amount, approximately five turns.

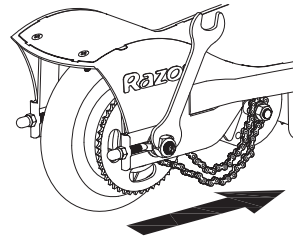

3 With two 13mm wrenches, loosen the axle. Slide the wheel forward to loosen the chain.

4 Remove wheel.

Note the sequence of the hardware:

Right Side (Throttle)

- 18-1 M8 Nut
- 18-2 Washer
- 18-3 Axle adjuster eye bolt
- 18-4 U Piece
- 18-5 M6 Locknut
- 18-6 Cap
- 18-7 Plate cut washer
- 18-8 Thick cut washer
- 18-9 (Short) spacer

Left Side (Brake)

- 18-1 M8 Nut
- 18-2 Washer
- 18-3 Axle adjuster eye bolt
- 18-4 U Piece
- 18-5 M6 Locknut
- 18-6 Cap
- 18-7 Plate cut washer
- 18-8 Thick cut washer
- 18-9 (Long) spacer

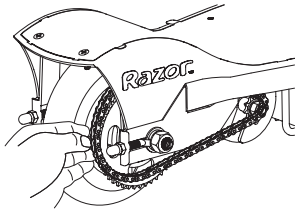
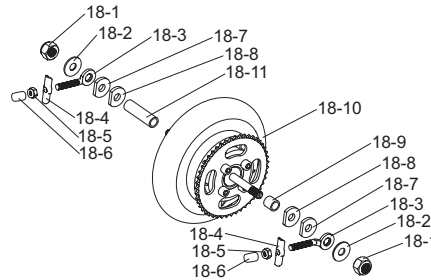

5 Install new chain or wheel by maneuvering the chain onto the sprocket and slipping the axel into the slots on the frame.

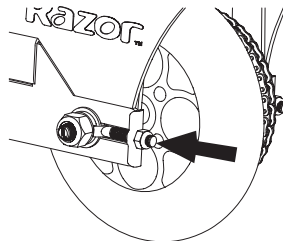

6 Install the axle adjusters and axle nuts. Tighten until they just barely hold the hardware in place.

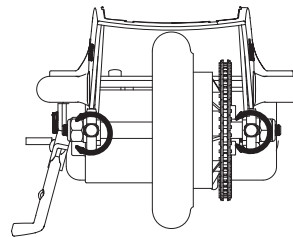

7 Tighten both axle adjusters the same number of turns to fine-tune the tension on the chain and center of the wheel.

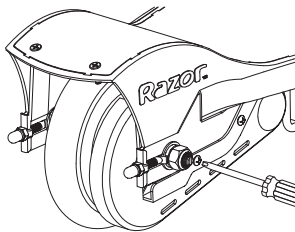

8 Replace the chain guard.

Need Help? Visit our web site for replacement parts, product support and a list of authorized service centers at www.razor.com or call toll free 866-467-2967 Monday - Friday 8AM - 5PM Pacific Time.