

IZIP Tricruiser

Rear-end Assembly Replacement



Required Tools:

- 8mm box wrench
- 10mm box wrench
- 17mm box wrench
- 5mm Allen wrench
- Phillips-head screwdriver
- Needle-nose pliers
- Scissors or diagonal cutters

Preparation:

Quick reference:

1. Remove the basket and fenders.
2. Remove the battery.
3. Break the front-rear transfer chain master link and remove the chain.
4. Open the controller compartment and disconnect the motor. Cut any cable ties holding the motor wire to the frame.
5. Remove the seatpost, then flip the tricycle upside-down.

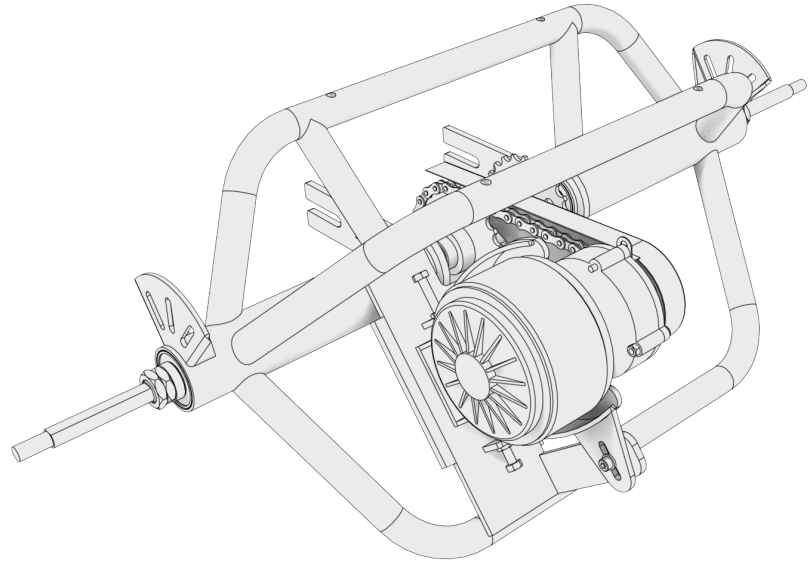

Step 1

a) Remove the basket from the rear of the trike, using an 10mm box wrench and a Phillips-head screwdriver.

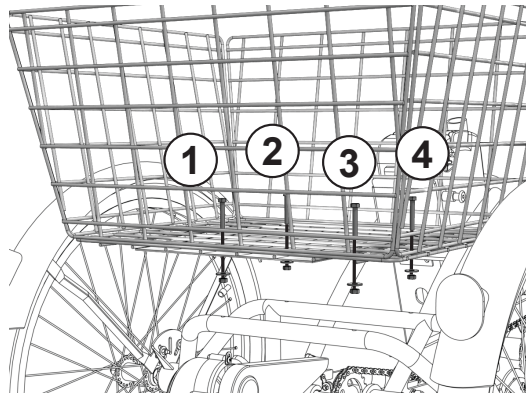

b) Remove the fenders from the trike, using an 8mm box wrench and a Phillips-head screwdriver.

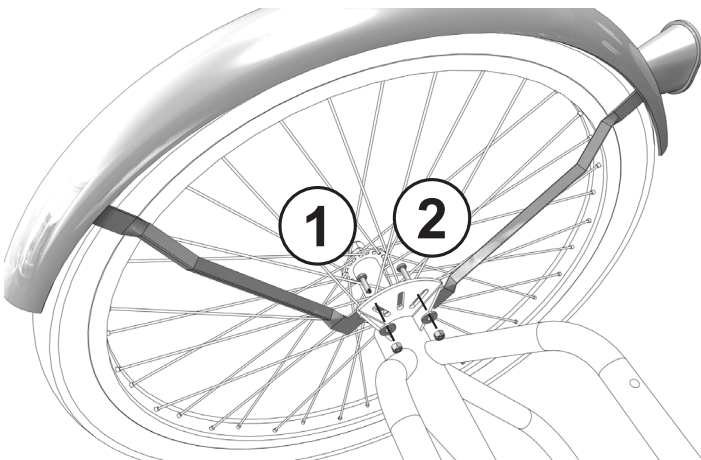

Step 2

Remove the seat and seat post assembly.

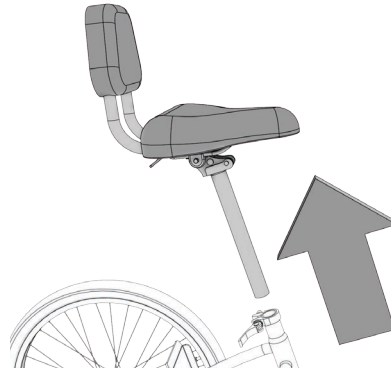

Step 3

Locate the front-rear “transfer chain”. It is the middle of the three drive chains. Locate the master link, then using a pair of needle-nose pliers, slide off the slotted faceplate

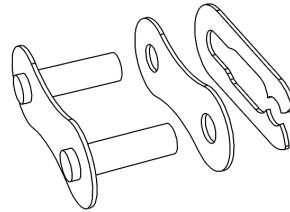
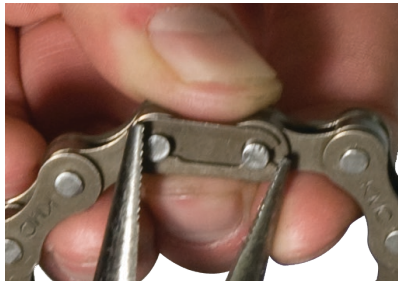
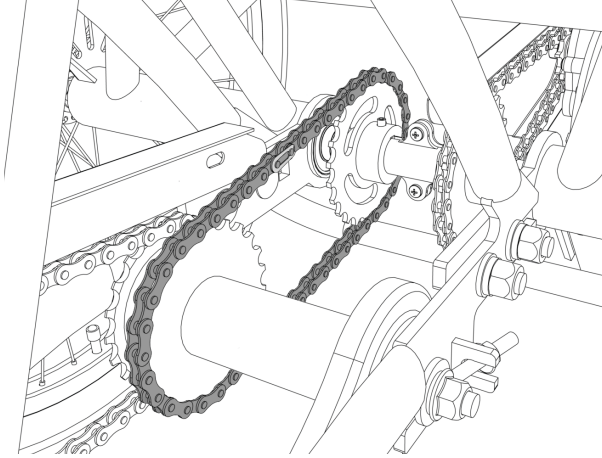

Step 4

a) Locate the controller compartment, located under the battery. Remove the three Phillips-head screws holding the side plate onto the left side of the compartment.

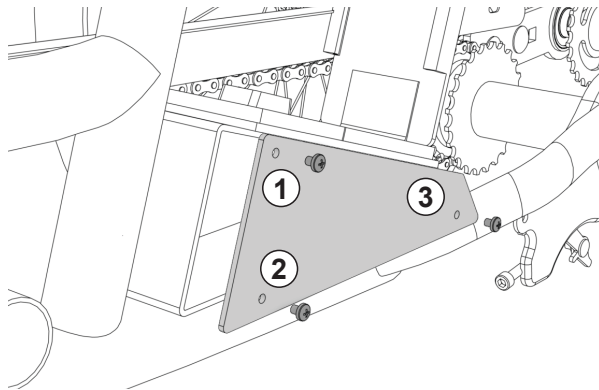

b) Inside the controller compartment, disconnect the motor connector from the silver controller box. It has a large white plug and two wires, green and blue. Cut any cable ties holding the motor wire to the frame, then coil the wire so it doesn't get in the way later.

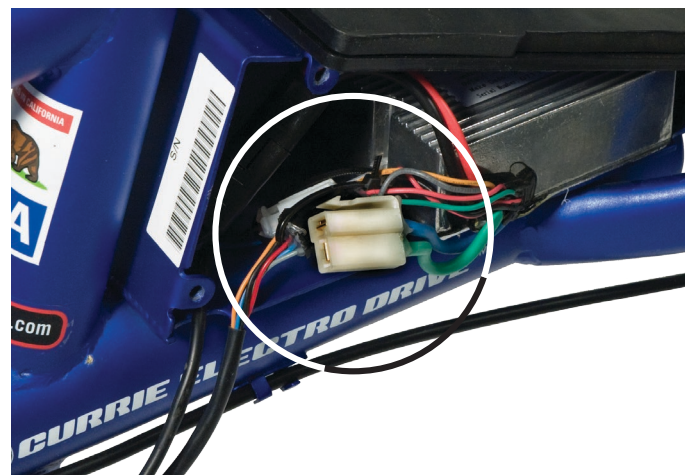

Customer Support: 1-800-377-4532

Revised: June 15, 2012 9:04 AM

Step 5

a) Remove the battery from the tricycle.

b) Flip the tricycle upside down. It should rest on the top of the seat tube (where the seat post was inserted previously), and on the handlebars. Be careful not to damage any handlebar-mounted accessories like the brake levers or throttle.

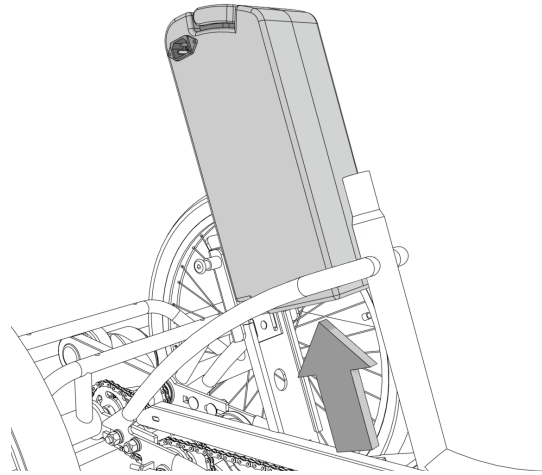

Rear-end removal:

Quick reference:

1. Remove the rear wheels.
2. Loosen the four carriage bolts connecting the front and rear sections of the tricycle.
3. Slide the front and rear sections of the tricycle frame apart.

Step 1

Remove the rear wheels. You will need to use a 17mm box wrench to loosen first the locknut, then the inner nut on each side.

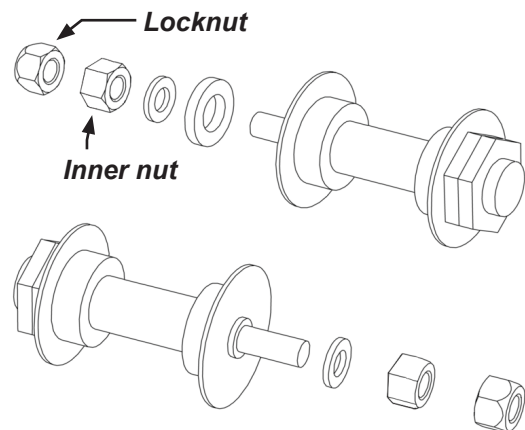

Step 2

Loosen, but do not remove, the four large carriage bolts that connect the front section of the tricycle to the rear.



Step 3

The front and rear sections of the tricycle are now free to slide away from each other. Be careful when removing the rear end, as it is heavy.



Re-assembly:

Quick reference:

1. Slide the new rear assembly into the main frame.
2. Re-attach the front-rear transfer chain and set its tension.
3. Tighten the four carriage bolts to secure the front and rear sections together.
4. Re-install the two rear wheels, the basket, and the fenders.
5. Re-connect the motor to the controller.

Step 1

a) Transfer the two large carriage bolts attached to the old rear-end unit to the new unit, in the same positions.

b) To assist in the next step, make sure the heads of the bolts attached to the rear end sub-assembly are flush with the frame. The bolts attached to the frame itself should be flush in the opposite direction.

Slide the rear-end assembly into the main frame, making sure the washers attached to the four carriage bolts sit to the outside of the frame, against the nuts. Make sure the rear axle is at a right angle to the frame, but do not tighten the bolts yet.

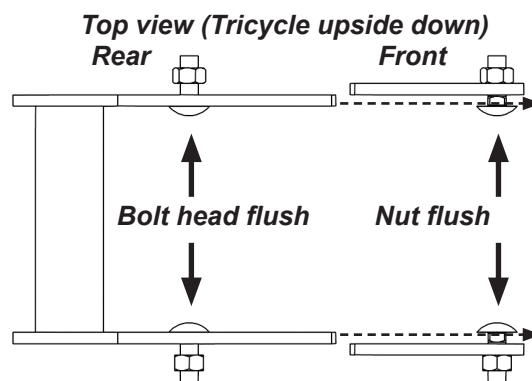

Step 2

Find the front-rear transfer chain you removed in the preparation section of this guide.

Wrap the chain around the two free cogs, then re-assemble the master link. Close the master link with a pair of needle-nose pliers.

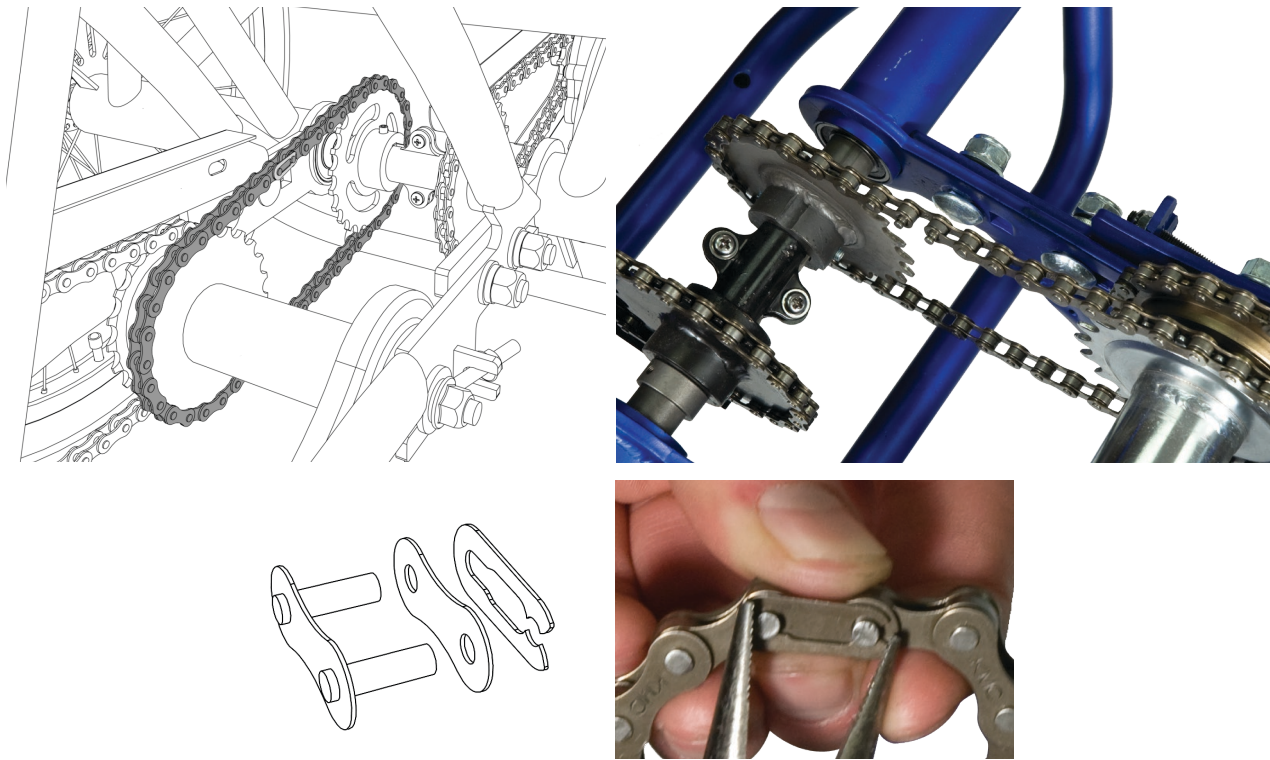

Adjust the tension of the transfer chain by sliding the rear end towards or away from the main frame; when properly adjusted the chain should have about 1/8in (3mm) of vertical play. Be sure the rear axle remains perpendicular to the frame.

Step 3

Make sure the front and rear frame sections are perpendicular to each other. Tighten the four carriage bolts from step 1, then re-check the rear-end alignment and transfer chain tension.

Step 4

a) Re-attach the rear wheels. Notice that one rear axle has a flat section, while the other does not. This prevents the wheels from being incorrectly installed. Attach the rear wheel hardware as shown in the diagram, then tighten the four axle nuts securely with a 17mm wrench.

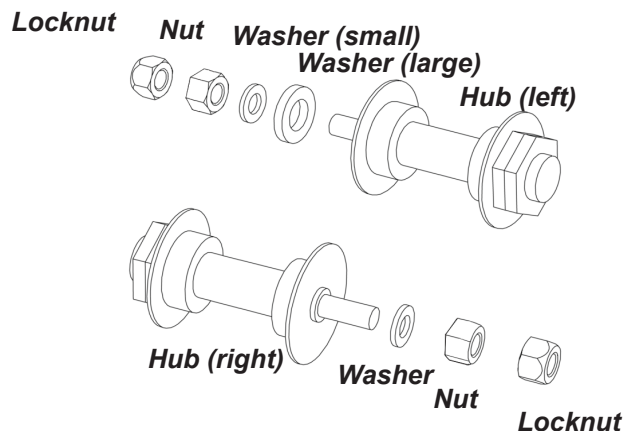

b) Re-attach the fenders and basket, referring to the images in step 1 of the “preparation” section of this guide if needed.

Customer Support: 1-800-377-4532

Revised: June 15, 2012 9:04 AM

Step 5

Route the wire from the motor to the controller compartment, securing it to the frame as before with zip-ties. Plug the motor into the controller, then close the controller compartment.

